



Al Arif Contracting Co. LLC, PO BOX 6170, Dubai, UAE  
Tel: +971 4 3979555 Fax: +971 4 3979666 E-mail: alarifco@alarifgroup.ae  
[www.alarifgroup.ae](http://www.alarifgroup.ae)

## Corporate Credentials



  
شركة العارف للمقاولات ذ.م.م.  
AL-ARIF CONTRACTING CO.(LLC)

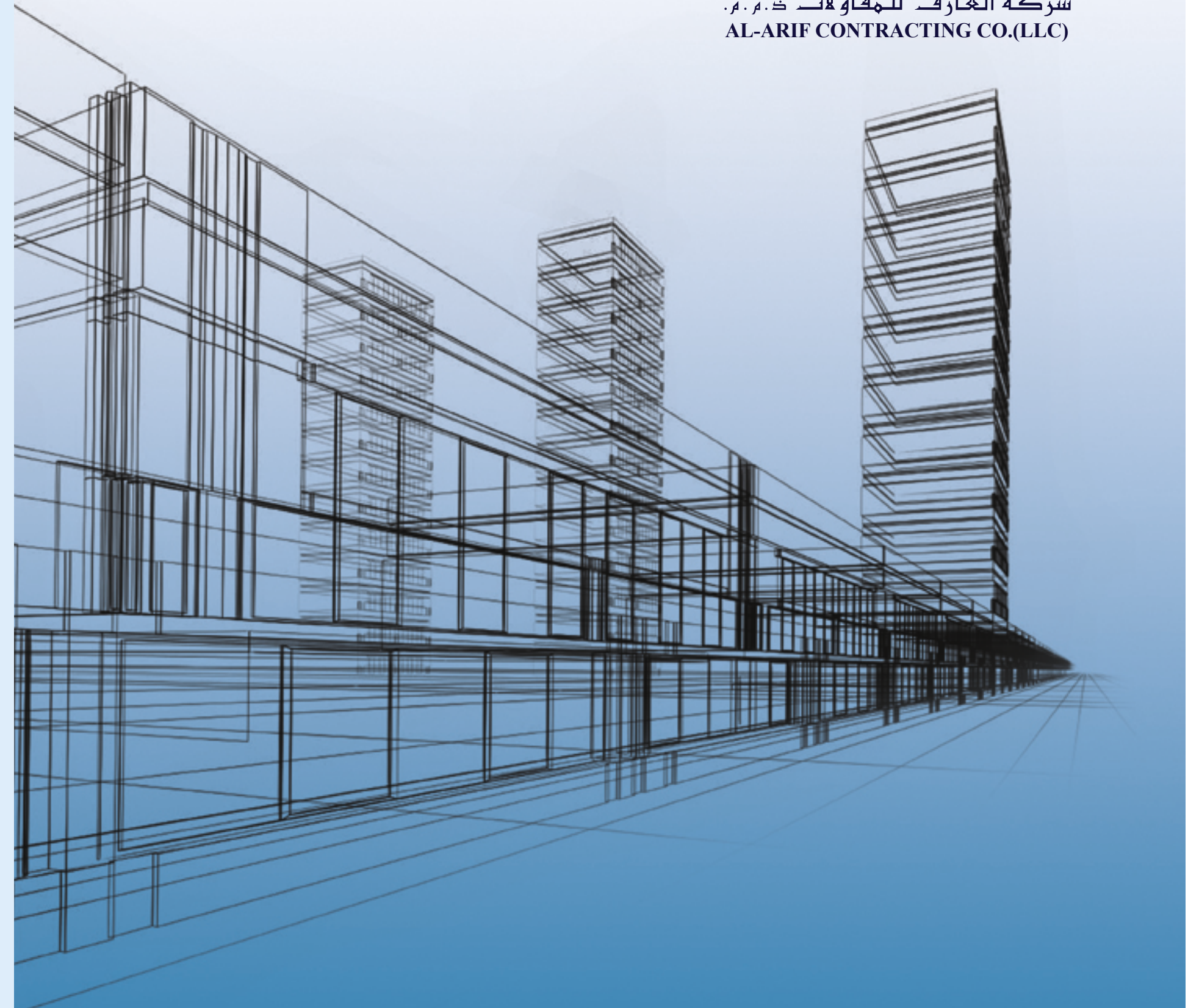

**Corporate** Credentials





شركة العارف للمقاولات ذ.م.م.  
AL-ARIF CONTRACTING CO.(LLC)



Creating landmarks in the Emirates since 1975

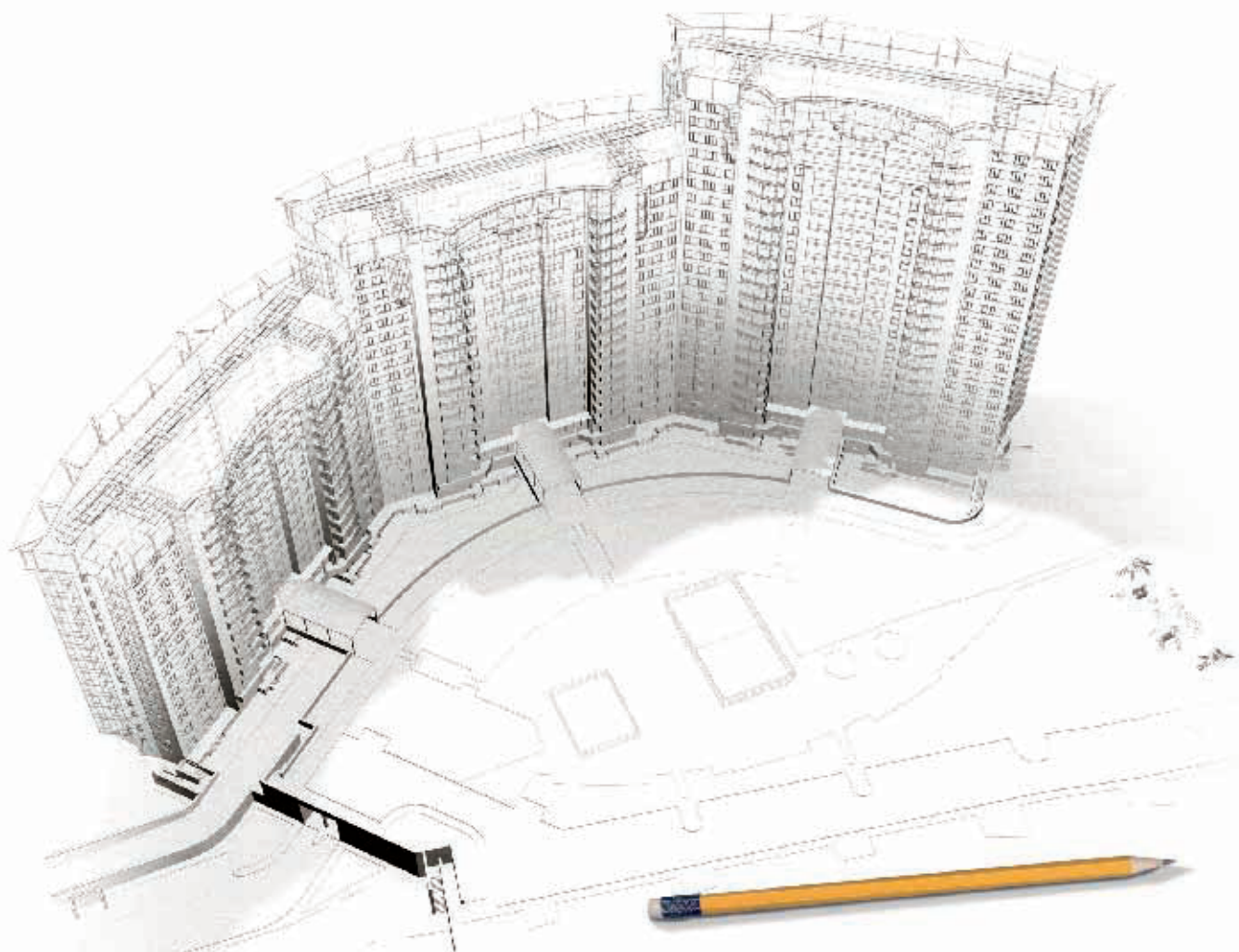





Al Arif Contracting Co. LLC, PO BOX 6170, Dubai, UAE  
Tel: +971 4 397 9555 Fax: +971 4 397 9666 E-mail: [alarifco@alarifgroup.ae](mailto:alarifco@alarifgroup.ae)  
[www.alarifgroup.com](http://www.alarifgroup.com)

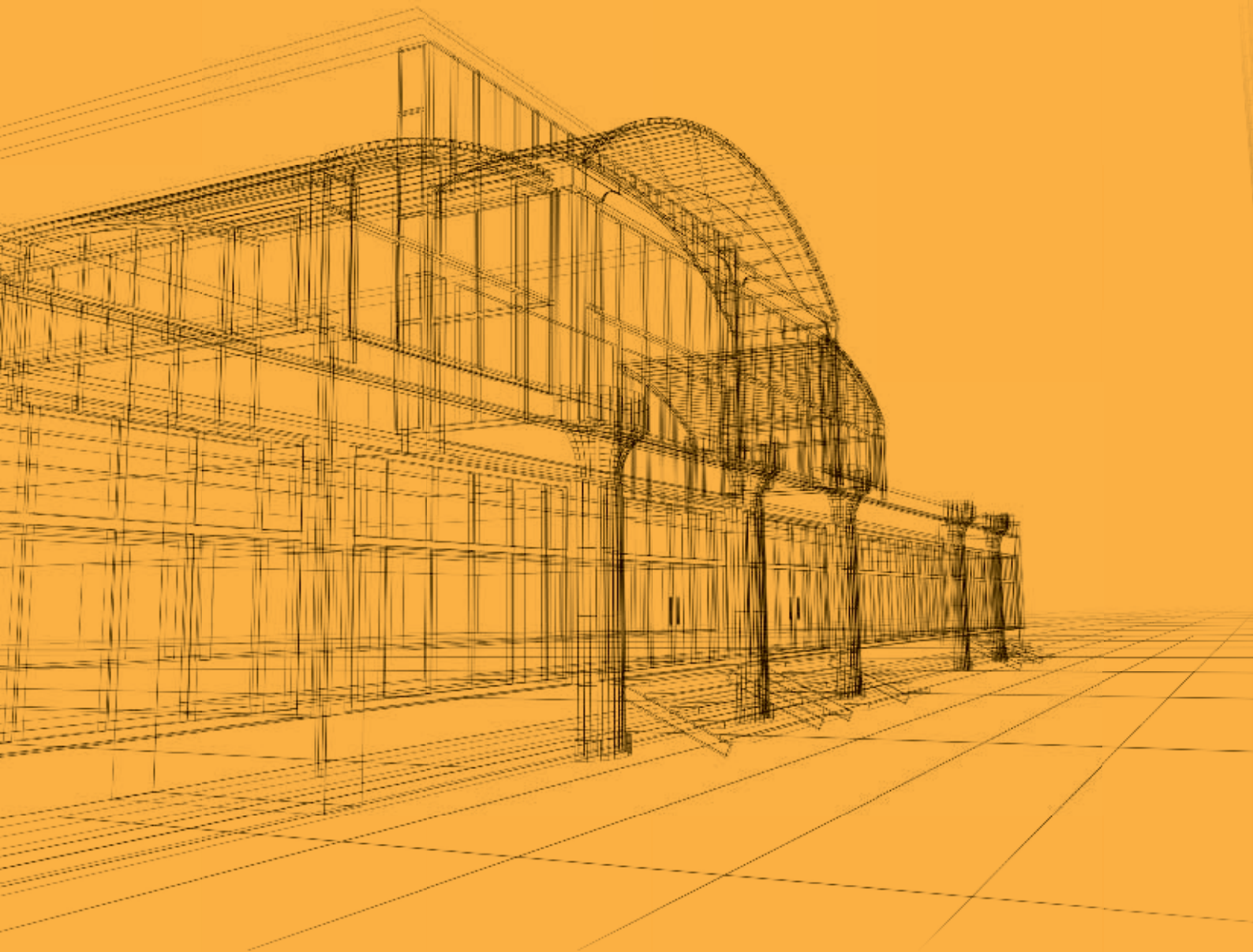



- • Chairman's Message
- • Organization Chart
- • Al Arif Contracting Co. LLC
  - Introduction/Vision/Mission
  - Infrastructure
- • Al Arif Group
  - Introduction/Related Group Companies List
  - Power Factor Electromechanical Works LLC
  - Al Arif Joinery Works and Interior Fitouts
  - Stromeek Emirates Foundation LLC
  - Pivot Aluminium Co. LLC
  - Pivot Metal Construction Co. LLC
- • Project Highlights
- • Health & Safety Policy
- • Certification
- • Documents
- • Resources





# Chairman's Message

With the grace and blessings of God, sailing back to 1975's on a peaceful morning, Mr. Abdul Karim N. Al Arif and Mr. Abdul Razak A. Al Mutawa together formed a contracting company in the family name of Al Arif.

When I look back at our humble beginnings, I can hardly believe our business and our country have come so far, so fast. We have faced many challenges in our journey to excellence and we have been always competent enough to surpass them.

Today the world is moving towards the innovations in digital technology and evolution of mobile communication. All the countries in the globe were challenged due to the globalization and liberalizations. Due to our feet firmly on the ground and our vision far beyond the horizon, we will continue to be a partner in this development of the United Arab Emirates.

For the last three decades our Group has moved through immense stages from inception to its growth and expansion. Our Group itself has witnessed and is still witnessing major developmental activities in many sectors such as construction, real estate, investment, manufacturing, travel and tourism, trading, and food and beverages to name a few.

With the growth of Dubai as the commercial hub of the region, the Group has emerged as a strong leader in all fields of business.

The flag off to our growth started in the year 1995.

Today, Al Arif Group is set to expand its influence in the GCC as well as to other parts of the globe, Insha Allah.

*Hamad Abdul Karim Al Arif*

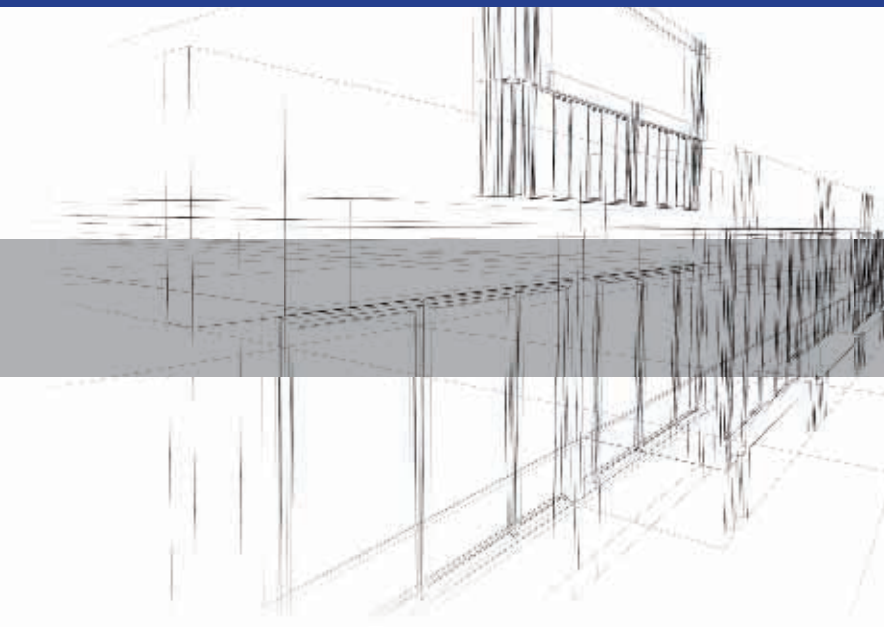





## OUR AUDITORS

---

### EXTERNAL AUDITOR

M/s. Ernst & Young

---

### INTERNAL AUDITOR

M/s. Price Waterhouse Coopers





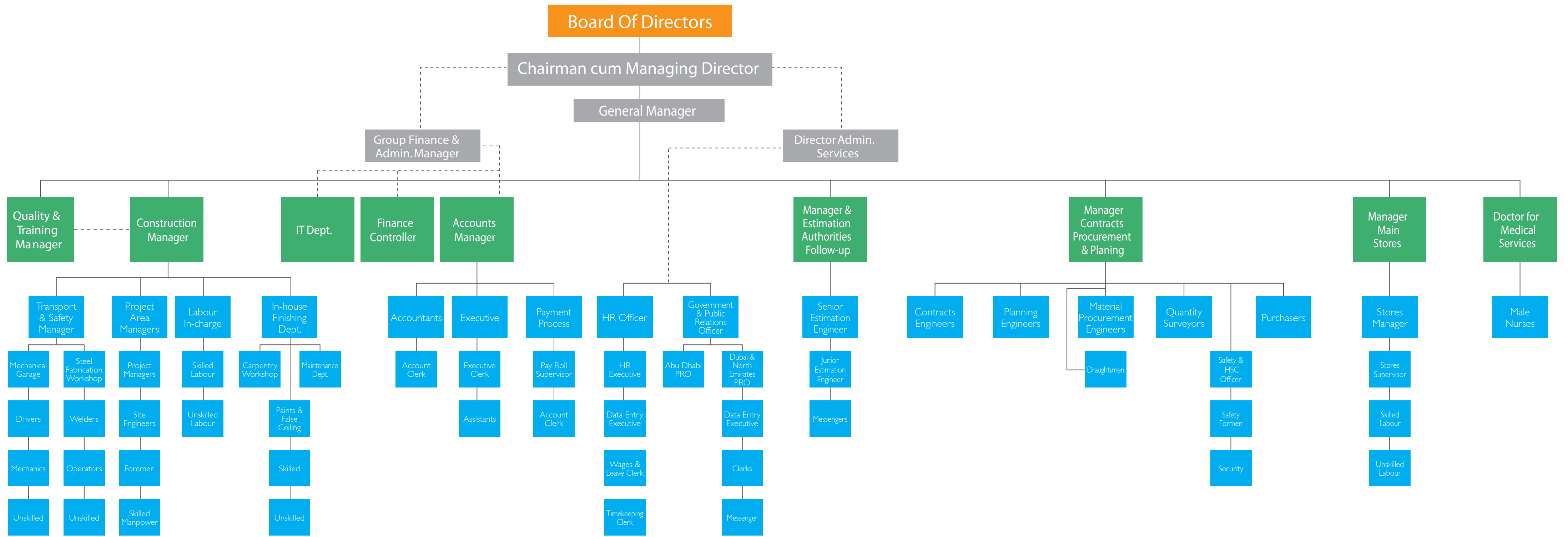



# AI Arif Contracting Co. LLC

## Success Built on Experience

AI Arif Contracting Co. was established in 1975, making it one of the oldest contracting companies in the UAE. The company is renowned for its quality and has completed over 475 construction projects that include prestigious commercial and residential buildings, schools, hotels, villas and warehouses in Dubai and the Northern Emirates.

Since its inception in 1975, AI Arif Contracting Co. has earned an excellent reputation, thanks to its professional management, experienced technical staff and large scale plant and equipment capacity. The timely completion of projects and provision for excellent services within the prescribed budget has established AI Arif Contracting Co. as a highly credible company.

## Vision

AI Arif aims to establish unified and world class construction services for customers, capitalise on the region's booming construction scenario with a strategic plan, and to achieve minimum resource utilisation and maximum productivity.

## Mission

AI Arif's commitment towards the community is to manage and exceed all the expectations of Quality, Trust and Spirit of Innovation with excellence.



## Equipped for Performance

When it comes to delivering quality at par with global standards, Al Arif Contracting maintains its standards with the latest plant equipment comprising of tower cranes, forklifts, scaffolding equipment, big mixers, excavators, compressors, generators, concrete machines etc. A wide array of vehicles including big shovels and loaders, multiple trucks, trailers, pickups, loading machines, heavy duty construction vehicles, buses etc. add to the support.

## Labour Camps

Al Arif Contracting owns many labour camps with full residential facilities in multiple locations in the UAE.

## Warehouses

Al Arif Contracting has warehouses with enormous capacity for storing steel, cement, electrical equipment, tools and equipment, paints, machine parts, wood, sanitary, plumbing and PVC items, etc.





## Delivering Standards Beyond Expectation

Power Factor is a turnkey solution provider for MEP works and specialists in designing, installation and commission for various business sectors around the globe.

State-of-the-art technology combined with theoretical and practical knowledge of providing systems based solutions, have made Power Factor emerge as one of the premier MEP and office automation systems design, installation and commissioning companies.

Service excellence and customer satisfaction is the key to all services provided by Power Factor. With an increasing demand from varied sectors both locally and globally, Power Factor is fast making a mark in the following areas they specialise in:

- Plumbing and Drainage
- Mechanical Building Works
- Electrical Building Works
- Switchgear
- Fire Alarm and Fire Fighting
- Light Fittings
- Low Current Systems
- Air Conditioning
- Facility Management

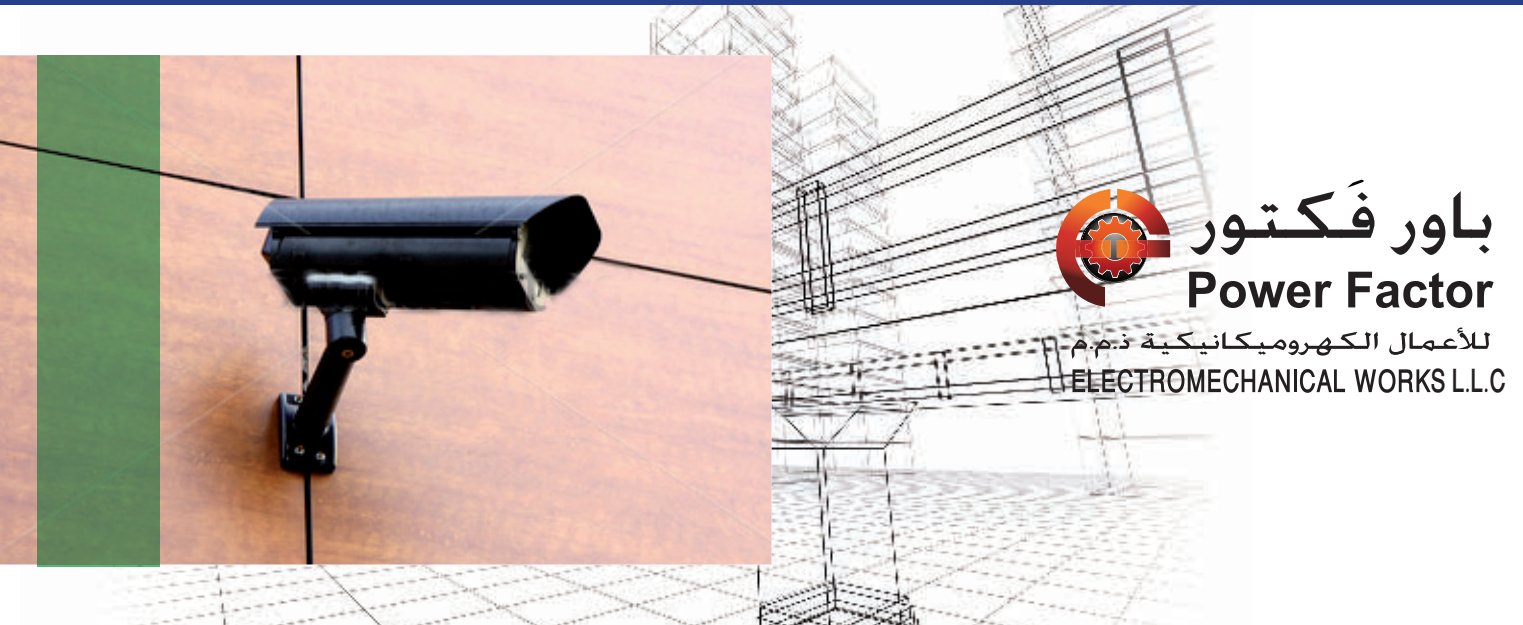

# Al Arif Joinery Works and Interior Fitouts

## Creating Impressive Interiors

Al Arif Joinery Works and Interiors has grown over a period of 30 years and developed into a full fledged interior decorating unit undertaking jobs on a turnkey basis.

The factory produces the finest quality of wooden doors, furniture, wardrobes, kitchen cabinets, gypsum works, partitions and false ceilings that can be supplied and installed by Al Arif craftsmen with a provision for client installation if required.

Al Arif has established a benchmark in quality and reliability of interior products and is highly regarded by local and international customers for its quality assurance. Trained and skilled craftsmen ensure that product durability and finish is at par with global standards.

The factory is fully equipped with the latest technical equipment to undertake any large-scale production of doors of various patterns and finishes.

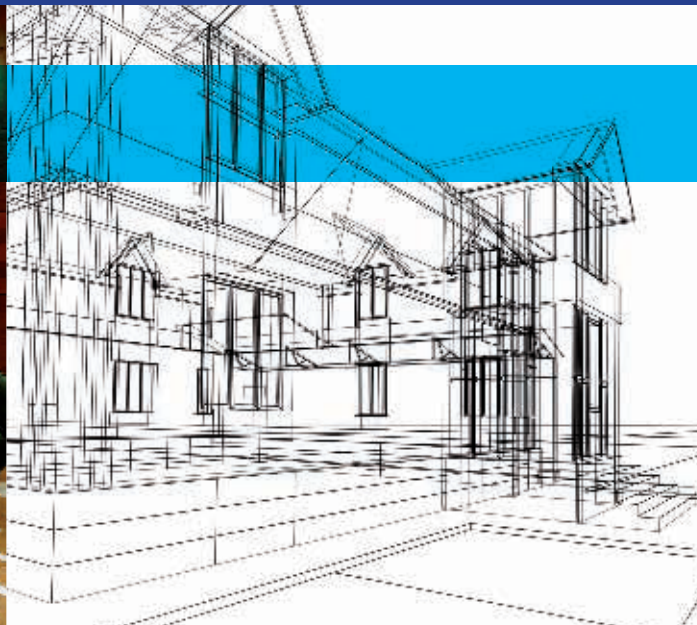



## Building Strong Foundations

Stromek Emirates Foundations LLC was established in Dubai in 1994 and since then has grown to become one of the leading specialised contractors in mechanical foundations for the construction industry with more than 500 successfully completed projects. The company has continually adopted new technology and techniques to offer customers a range of different types of foundation work, piling, shoring, ground anchors, earth support and soil injection.

Stromek can execute foundation contracts swiftly and with the highest quality standards using a wide range of drilling rigs plus service cranes and drilling accessories such as betonies mixers, decanters, drilling tools, buckets, augers, pile testing equipments, and concrete pumps.

## The Stromek Edge

Stromek drilling rigs have capacities of up to 24 mt drilling torque, which provide drilling diameters from 500mm up to 1500mm and depths up to 50 metres. Stromek has anchor drilling rigs which can drill and fulfil most ground anchor, soil injection and micro pile requirements. Stromek also has vibrohammers crane mounted and mast supported, which are used for driving sheet piles, steel soldier piles and other applications.

Different deep foundations, earth support and shoring systems such as board piles, CFA piles, driven piles, steel soldier piles, contiguous piles, secant piles, and tie back anchors are used in foundation piles up to 1500mm diameter, 50 meters deep, and to support excavation depths up to 115 meters. Stromek can offer alternative systems if more depth is required.

## Major Projects Undertaken

- 1- Al Taamier Tower, Silicon Oasis, Dubai
- 2- Diamond 6 Building, Dubai Marina
- 3- Al Owais Shopping Centre, Mirdif, Dubai
- 4- Awqaf Building, Dubai
- 5- Damase Hotel, Fujairah
- 6- G + 4p + 12 Floors, Damas Real Estate, Sharjah



ستروميك الإمارات  
للأساسات ش.ذ.م.م  
**STROMEK EMIRATES**  
Foundations L.L.C.



## Specialised Experts

Established in 1999, Pivot Aluminium built its early reputation as a reliable supplier of aluminium profiles, gaskets, hardware and glass from its premises in the industrial areas of Dubai. In addition, Pivot Aluminium encompasses in that premises facilities which allow it to provide to the local market a wide range of services related to the aluminium and glass sectors.

## Services Offered

- Design, fabrication, installation and maintenance of aluminium curtain walls, doors and windows, balustrades, handrails, claddings etc.
- Powder Coating of aluminium profiles
- Production of insulated glass unit (double glazing), tempered/heat strengthened glass, curved glass, laminated glass and sandblasted glass. In addition, edging, beveling and grinding of glass, CNC engraving on glass and other decorative services
- Design, fabrication, installation and maintenance of aluminium kitchen units

## Working Divisions

- Architectural Aluminium Division
- Powder Coating Division
- Glass Processing Division
- Aluminium Kitchens Division



PIVOT ALUMINIUM CO.LLC

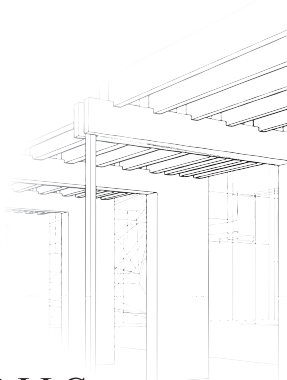



## Technologically Superior Expertise

Pivot Metal Construction Co. LLC is dedicated to the highest quality in Interior/Exterior Decoration/ Design, Architectural Metal Works, Stainless Steel Works, Wrought Iron Works, Carpentry and Joinery, Electroplating, Water Jet cutting, Metal Casting and Lathing, False Ceiling and Gypsum Works.

Pivot's Dubai, UAE, factory, set-up on modern lines and backed by the advanced technology, prides on being the only P.V.D. factory in the Middle East to provide the latest technology for environmental protection and corrosion resistance. Backed by over three decades of industry experience, Pivot Metal Construction Company has a qualified team of Designers, Engineers, Technicians and Site Experts who service various client requirements in diverse sectors like construction, hospitality, oil and natural gas and aviation.

## Services Offered

- Architectural Metal Works: Stainless Steel & Brass Works, Steel & Wrought Iron Works
- Carpentry and Joinery Works: Interior/Exterior Decorations and Turnkey Projects
- Metal Casting: Electroplating Works, Lathing and Machining
- Cladding Works
- Water Jet Cutting Works

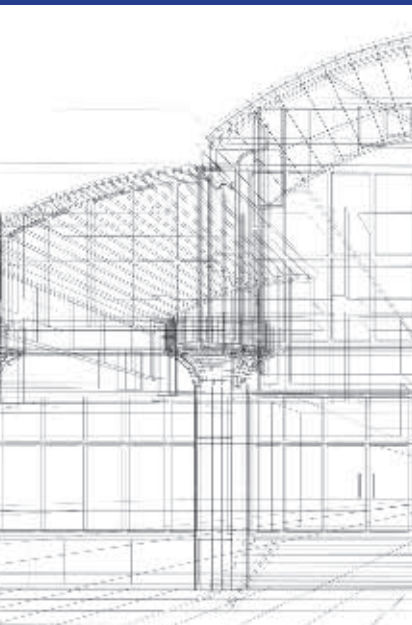

# Health and Safety Policy

## Maintaining a Safe Working Environment

The objective of Al Arif Group's Health and Safety Environment (HSE) is that every employee shall be encouraged to act responsibly at all times to prevent accidental damages, injuries and losses. Every reasonable effort shall be made and required action shall be taken at all times by the employees and the management to ensure the following:

- Build a work culture where safety comes first
- Participation of all employees in the improvement of Occupational Health & Safety system by taking care of their own health and safety, and that of others at the workplace through proper induction, effective job instruction, toolbox talks and with proper supervision
- Providing adequate and proper facilities and equipment and ensure their correct usage
- Preventive and corrective actions adopted are in accordance with DM recommendations and requirements







AL-ARIF  
CONTRACTING CO.LLC

Project  
Listings

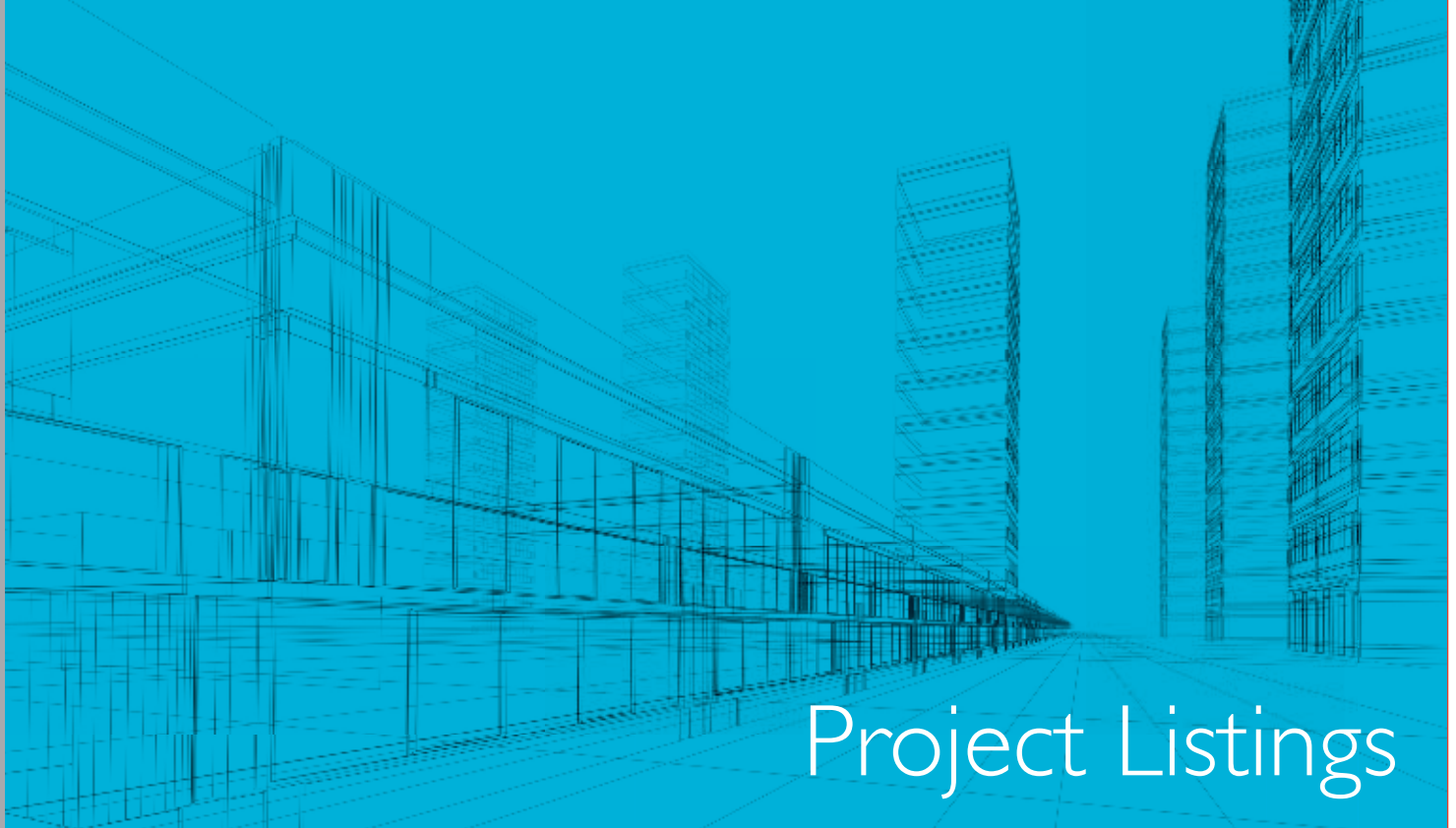

Project Listings





## CLIENT

Sheikh Hamad Bin Sougat

---

## CONSULTANT

Chawla Architects And Consultants

---

Hotel building with 2 basement + Ground + Mezzanine + 7 Floors  
located at Muraqabat in Dubai

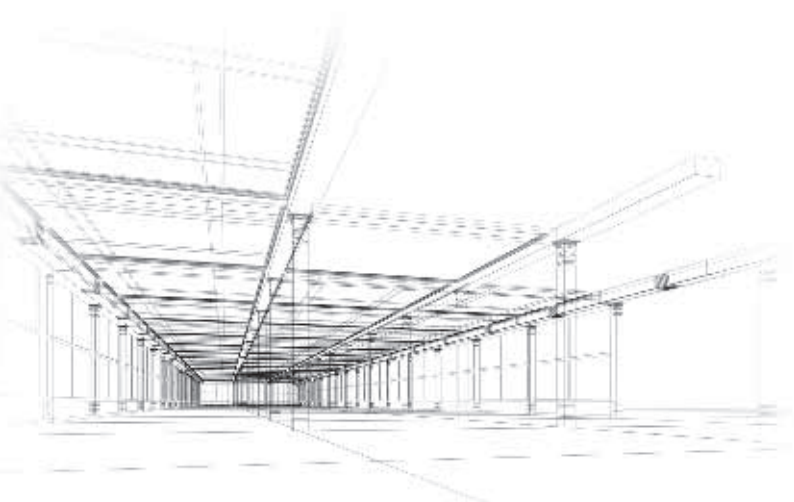



## CLIENT

Mohamed Abdul Latif Al Mulla

---

## CONSULTANT

Eng. Adnan Saffarini

---

A Commercial / Offices building with 2 basement + Ground + Mezzanine + 4 Floors located at Hor Al Anz in Dubai







## CLIENT

Abdul Razak Al Mutawa

---

## CONSULTANT

Dimension Engg Consultants

---

A Commercial / Offices building with 2 basement + Ground + Mezzanine + 5 Floors + H.C located at Al Karama in Dubai

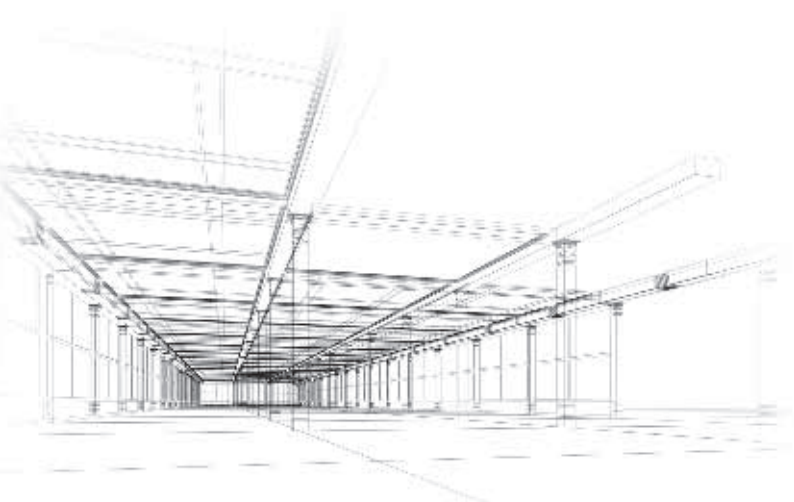



## CLIENT

Hussain Mohammad Rafi Fikri

---

## CONSULTANT

Eng. Adnan Saffarini

---

A Commercial / Residential building with 2 basement + Ground  
+ 4 Floors + H.C located at Al Bada in Dubai

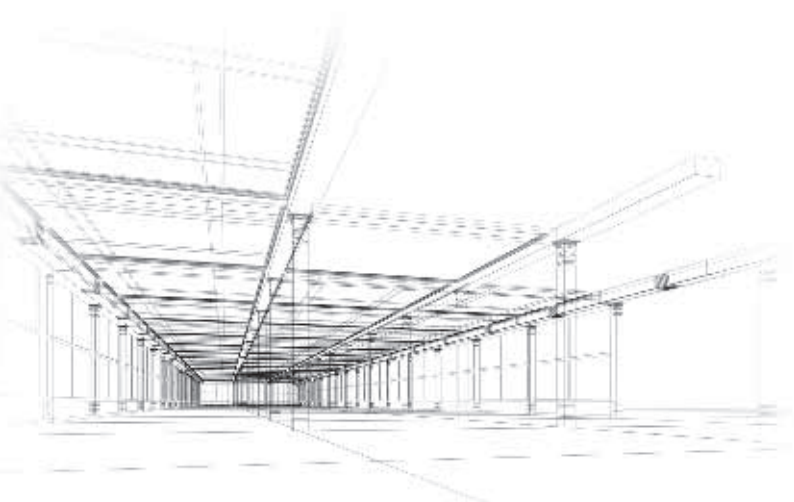



CLIENT  
Govt. Of Dubai

---

CONSULTANT  
Al Turath Engg Consultants

---

30 Nos. Govt. Houses Ground + I located at Zabeel in Dubai

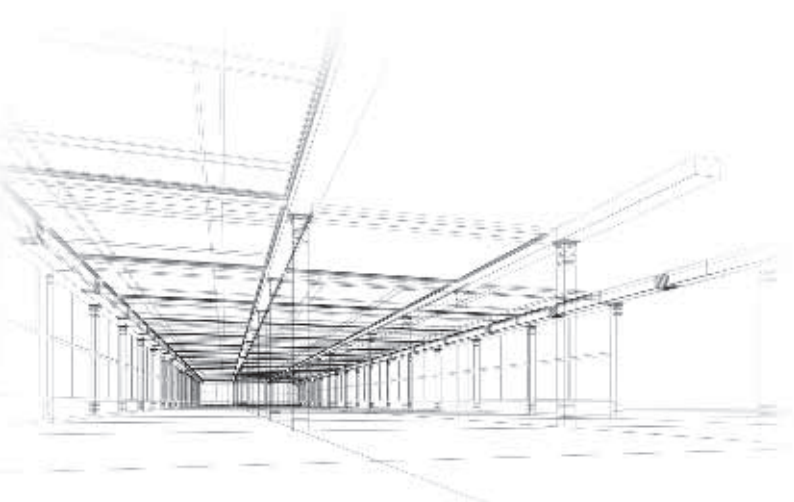

Ref.S 299





## CLIENT

Ali Ahmad Khaflan Bin Ghalitha

---

## CONSULTANT

Eng. Adnan Saffarini

---

A Commercial / Residential building with basement + Ground +  
4 Floors located at Al Karama in Dubai

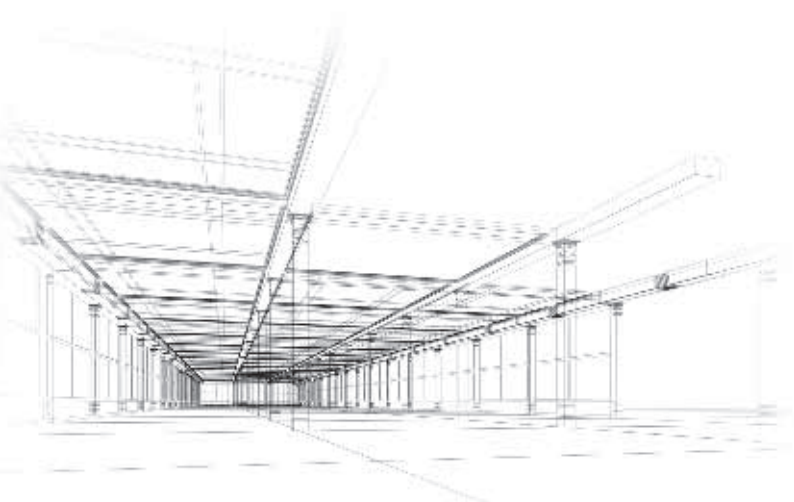



## CLIENT

Abdul Jalil Mahdi Al Asmawi

---

## CONSULTANT

Eng. Adnan Saffarini

---

7 Villas with Ground + I Floor + Gym & Services located  
at Al Bada in Dubai

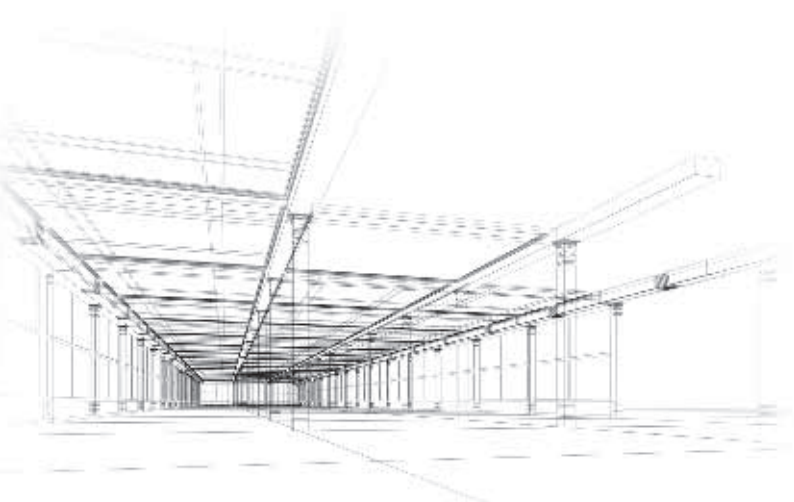



## CLIENT

Mohamed Sultan Ali Belshalat

---

## CONSULTANT

Eng. Adnan Saffarini

---

A Commercial / Residential building with basement + Ground +  
4 Floors + H.C located at Al Karama in Dubai







## CLIENT

Abdul Qader A.W. Al Sharfi

---

## CONSULTANT

Bel-Yoahah Engg Consultants

---

A Commercial / Residential building with basement + Ground +  
3+H.C located at Al Raffa in Dubai

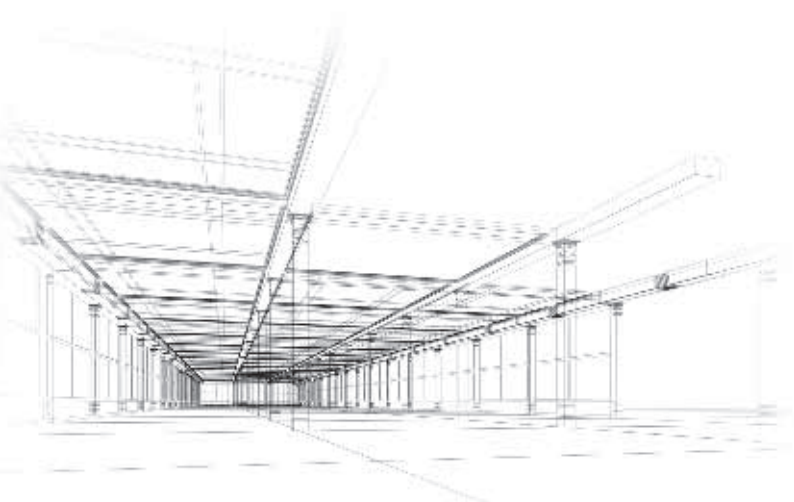



## CLIENT

Abdul Qader A.W.Sharafi And Hamad Al Arif

---

## CONSULTANT

Bel-Yoahah Engg Consultants

---

A Commercial / Residential building with basement + Ground +  
10 Floors + H.C located at Al Warsan in Dubai





## CLIENT

Manar Emirates Real Estate

---

## CONSULTANT

Dr. Samir Abdulla Eng Consultants

---

A Commercial / Residential building with Ground +  
3 Floors + H.C located at Al Hamriyah in Dubai







## CLIENT

Mohammed A.W. Al Sharafi

---

## CONSULTANT

Bel-Yoahah Engg Consultants

---

A Commercial / Residential building with basement + Ground +  
3 Floors located at Hor Al Anz in Dubai

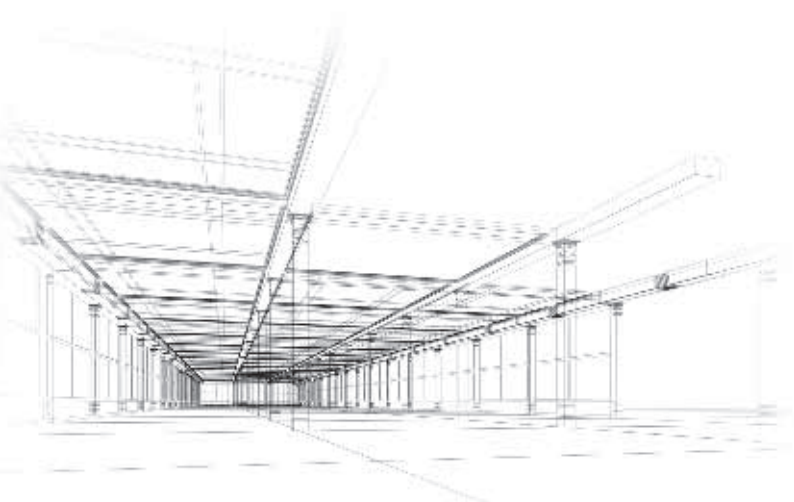



## CLIENT

Hamad Abdul Karim Al Arif

---

## CONSULTANT

Dr. Samir Abdulla Eng Consultants

---

A Commercial / Residential building with Ground + 5 Floors located  
at Souk Al Kabeer in Dubai

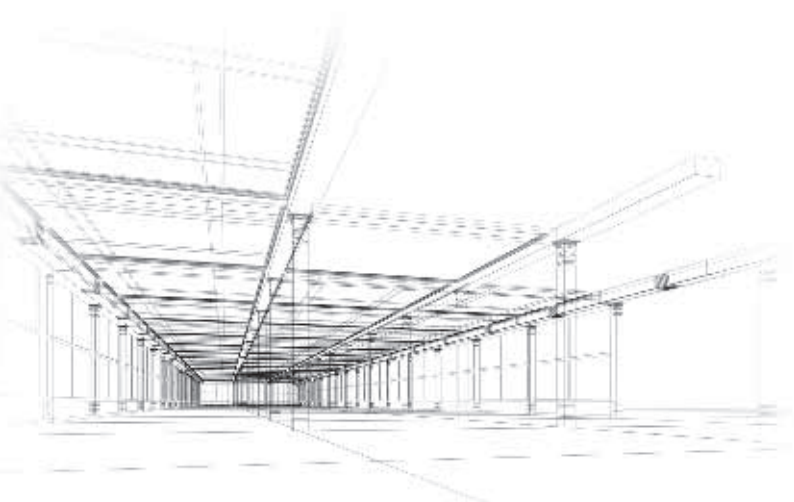



## CLIENT

Manara Emirates Real Estate

---

## CONSULTANT

Developments Consultant

---

A Commercial / Residential building with basement + Ground + Mezzanine + 3 Floors + H.C located at Al Karama in Dubai







## CLIENT

Awqaf and Minor Affairs

---

## CONSULTANT

Al Turath Engineering Consultant

---

A A Commercial / Residential building with basement + Ground + Mezzanine + 2 Floors + H.C located at Souk Al Kabeer in Dubai

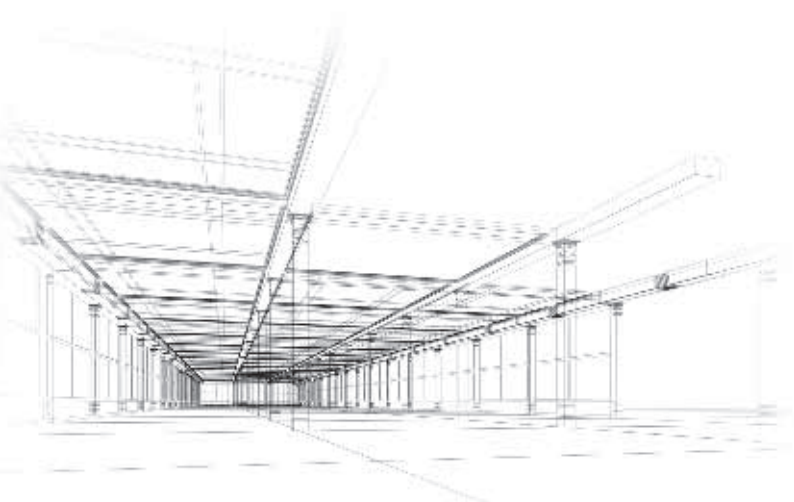



## CLIENT

Saeed Khalfan Ahmed Al Ghaith and Mr. Ali Badi

---

## CONSULTANT

Orion Engineering Consultant

---

A Residential building with 2 basement + Ground +  
8 Floors + H.C located at Al Barsha I in Dubai





## CLIENT

Mohammed Saeed Ahmed Bin Khediya

---

## CONSULTANT

Archdome Consultant

---

A Commercial / Hotel building with basement + Ground +  
2 + Gym Floors located at Jumeirah 1<sup>st</sup> in Dubai







## CLIENT

H.H.Sheikh Rashid Bin Saeed Al Maktoum (Wasl)

---

## CONSULTANT

Zabeel Consultant

---

A Commercial / Residential building with basement + Ground +  
3 + H.C Building located at Karama in Dubai

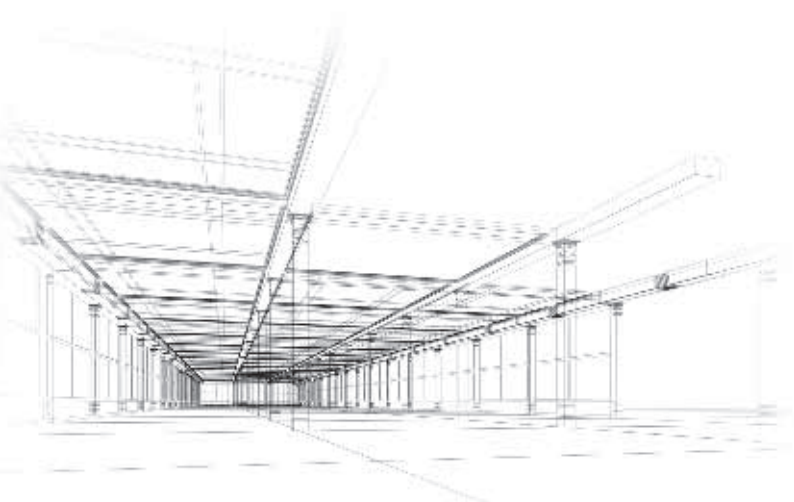



## CLIENT

Mohammed Sultan Hasan BulShalat

---

## CONSULTANT

Eng. Adnan Saffarini

---

A Commercial / Residential building with 2 basement + Ground + H.C  
+ 22 Floors Twin Tower located at TECOM in Dubai





## CLIENT

Dubai Investments

---

## CONSULTANT

Dewan Al Emara

---

DI Headquarters with basement + Ground + 6 + Roof located  
at Dubai Investments Park Dubai







## CLIENT

Dubai Investments Real Estate Company

---

## CONSULTANT

QHC Architect and Engineering

---

A Commercial / Residential building with basement + Ground +  
7 + H.C. Residential Bldg located at Al Nahda 1<sup>st</sup> Dubai

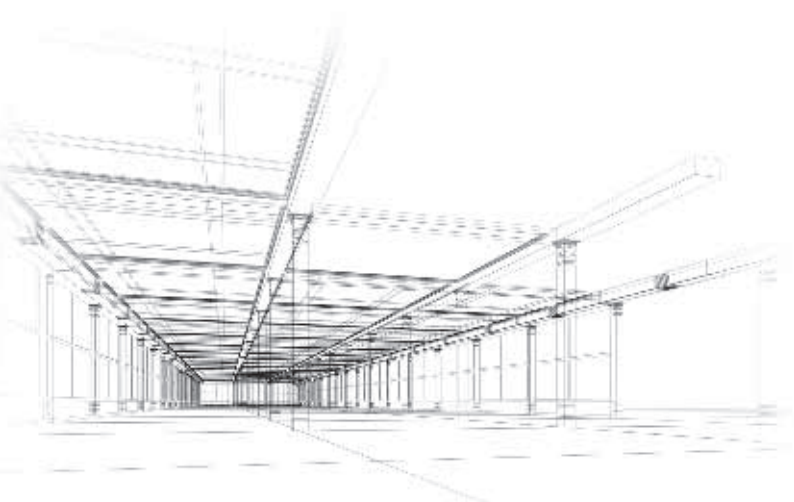



## CLIENT

Dubai Investments Park

---

## CONSULTANT

A 2 Z

---

A Commercial / Residential building with 2 basement + Ground +  
3 + GYM Residential Bldg located at Al Mankhool, Dubai

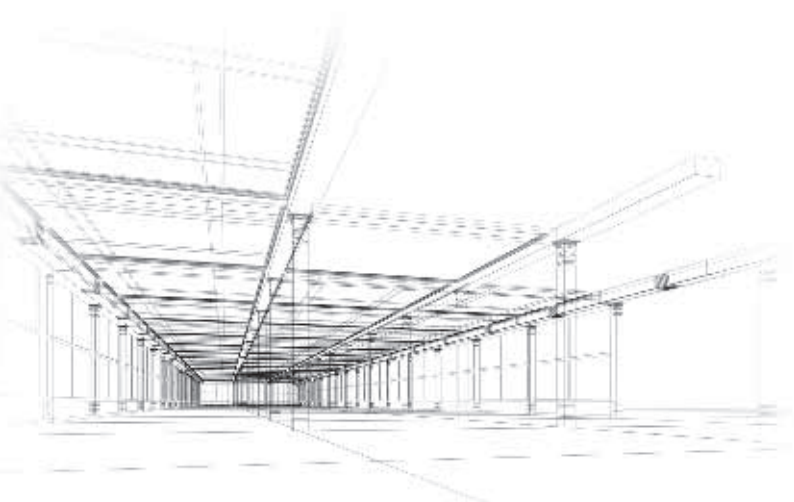



## CLIENT

Othman & Eisa Belshalat

---

## CONSULTANT

Adwar Engineering Consultant

---

A Commercial / Residential building with Ground + 6 Residential Bldg  
located at Al Warqa' a 1<sup>st</sup>, Dubai







CLIENT  
Chapal World

---

CONSULTANT  
Eng. Adnan Saffarini

---

A Commercial / Residential building with 3 basement + Ground +  
23 + Roof Residential Bldg located at Dubai Sports City, Dubai

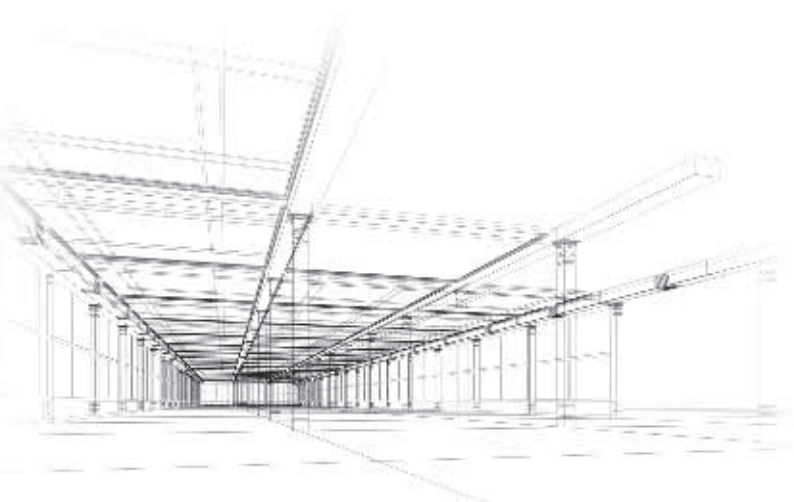

Ref.S 430



## CLIENT

Salah Awad Al Fargalh

---

## CONSULTANT

Mazaya Consulting Engineers

---

A Commercial / Residential building with Ground + 5P + H.C. + 25  
Residential Bldg located at Al Khan, Sharjah



Ref.S 434



## CLIENT

Hureia Al Syed Abdulkader Ekuider

---

## CONSULTANT

Mazaya Consulting Engineers

---

A Commercial / Residential building with Ground + 5P + H.C. + 18  
Residential Bldg located at Al Mamzar, Sharjah







## CLIENT

Mazda Showroom & Workshop

---

## CONSULTANT

Arif & Bint oak

---

A Car showroom and workshop  
at Al Quoz 1<sup>st</sup>, Dubai

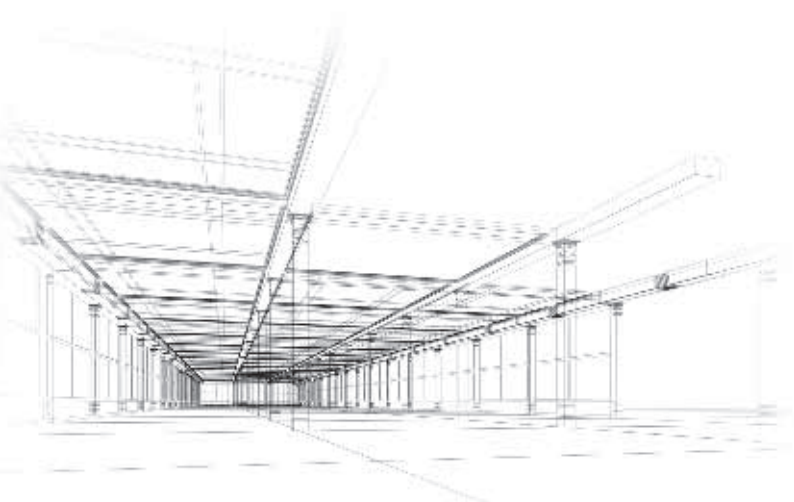



## CLIENT

Ahmad Mohammad Saeed Bin Humaidan

---

## CONSULTANT

Al Ajmi Engineering Consultants

---

A Residential building with basement + Ground +  
12 Floors at Al Nahda 2nd in Dubai





CLIENT  
Dubai Municipality

CONSULTANT  
Gulf Engineering & Consultants

Al Fahidi Market at Bur Dubai, Dubai

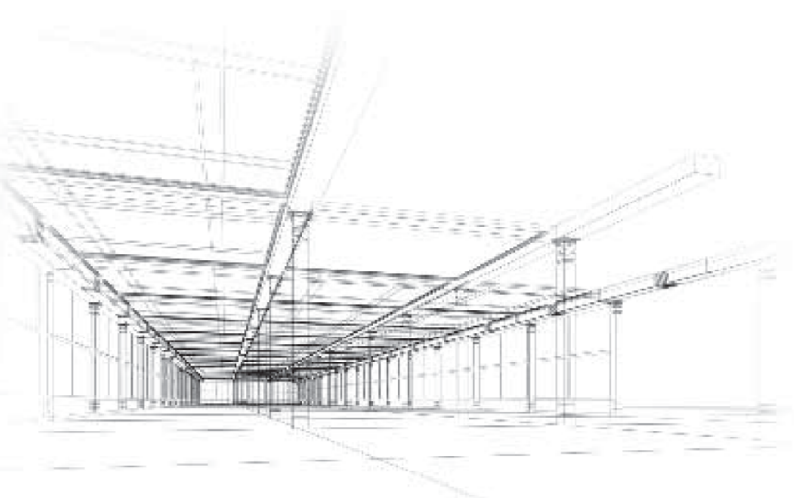





## CLIENT

Mona Ali Mohd Ali

---

## CONSULTANT

National Engineering Bureau

---

A Residential building with 2 basement + Ground +  
10 Floors + H.C at Al Qusais in Dubai

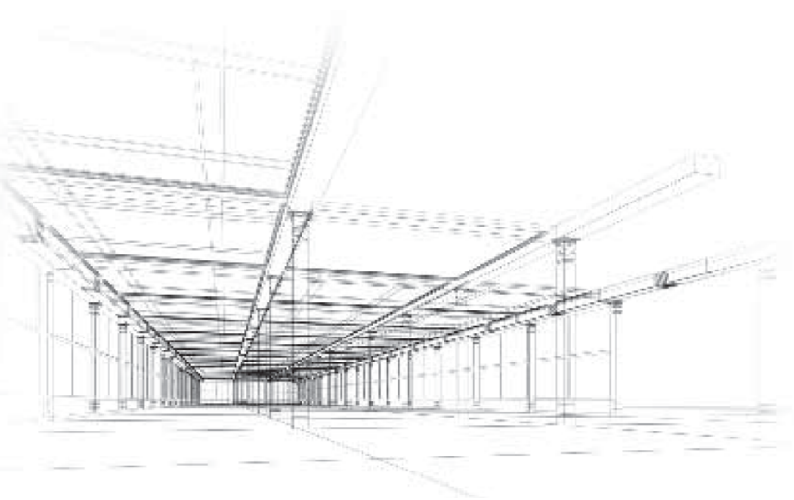



AL-ARIF  
CONTRACTING CO.LLC



Project  
Details



Project Details



مجموعة العارف  
AL-ARIF GROUP

## Major Running Projects

S.No	REF	PLOT No.	PROJECT	LOCATION	CLIENT	CONSULTANT
1	401	C007-01, 012	2B+G+22+HC Twin Tower	Tecom, Dubai	M/s. Mohd Sultan Hassan Bulshalat	M/s. Adan Saffarini
2	407	316-887	2B+G+6+HC	Al Rafa, Dubai	M/s. Manar Emirates Real Estate	M/s. QHC Engg.
3	409	316-610	2B+G+5+HC	Al Rafa, Dubai	M/s. Abdul Qadir A.W. Al Sharafi	M/s. Next Engg. Consultants
4	415	598-1080	2B+G+4+HC (6 Bldg.)	Mirdif, Dubai	M/s. Dubai Investment	M/s. Al Shurooq Engg. Consultants
5	417	25/40 Silicon Oasis	2B+G+3P+20	Dubai	M/s. Al Arif Contracting Co.	M/s. Al Gurg Engg. Consultants
6	430	Dubai Sports City	3B+G+M+23+R	Dubai	M/s. Chapal World LLc	M/s. Adan Saffarini
7	438	810	G+3P+Services+ Restarant+ 15 flr.+HC+Helipad	Al Khan, Sharjah	M/s. Yaqoub Ben Abdul Raheem Ben	M/s. Gulf Sky Engg. Constantants
8	444	264-328	G+2 Labour Camp	Muhaisbah 2nd, Dubai	M/s. Galdari Brothers Co.	M/s. Architectural Design Unit
9	446	312-1547, 1548, 786	2B+G+M+2 Hotel, B+B+M+1 Office, B+G+M+1	Al Souq Al Kabeer, Dubai	M/s. Mohd. Sultan Hassan Belshalat	M/s. Adwar Engg. Consultants
10	460	312-544	2B+G+M+1 Comm.,	Al Souq Al Kabeer, Dubai	M/s.Fardan Ali Fardan Al Fardan	M/s. Al Hatmy & Eng. Consultancy
11	469	333-452	92 Luxury Villas - Residential	Al Bada, Dubai	M/s. Al Wasl LLc	M/s. Arif & Bint oak Consulting, & Architects Enggs.
12	473	256-211	G+1 Twin Villas- Residential (11 No's)	Umm Sequim, Du	M/s. Easa Saleh Al Gurg LLc	M/s. Face Consultant
13	475	C-005018	2B+G+1P+6+Roo f Residential	Tecom, Dubai	M/s. Mohamed Mahran Albaloushi	M/s. Palace Engineering Consultants
14	480	442-4464, Al Warqaa 4th	G+1 Private School	Al Warqaa, Dubai	M/s. The School of Research Science	M/s. Bel Yoahah Architectural
15	483	129149	2B+G+11 Hotel Building	Port Saeed, Dubai	M/s. Mohamed Salem Saleh Al Mehnali	M/s. ARC Intl
16	485	364-719	Vehicle Body & Painting Work Shop	Al Quoz 1st, Dubai	M/s. Galadari Brothers LLc.	M/s. Arif & Bint oak Consulting
17	486	613-767	B+G+1 + P - Residential	Ras Al Khor Indust.2, Dubai	M/s. Ali Ahmad Khalfan Bin Ghalita	M/s. Adan Saffarini
18	489	317-1008	2B+G+7+HC Comm. Residential Bldg.	Mankhool, Dubai	M/s. A.W. Rostamani Holdings Co. LLc	M/s. Adan Saffarini
19	493	313-548	2B+G+M+3 Comm. Offices	Al Hamriya, Dubai	M/s. Utmost Properties	M/s. Arif & Bint oak Consulting



20	496	354-997	B+G+M+1 Comm. & Office Building	Al Quoz 1st, Dubai	M/s. Tayeb Mohammad Ibrahim	M/s. Al Ajmi Engineering Consultants
21	497	3730264	2B+G+6+HC, 4 Star Hotel	Al Barsha 1st, Dubai	M/s. Abnaa Alhaj Abdulla Abdulrahman Sharafi	M/s. Al Hashemi Planners, Architects Engg.
22	501	599-549	G+3+Roof, Labour Accommodation	Jabal Ali Industrial, Dubai	M/s. Cleanco General Cleaning Co.	M/s. Arch Dome Consultancy
23	505	362-451	B+G+1 + Second Mezz + Roof) Shopping Centre	UMM Suqeim, Dubai	M/s. Union Co-Operative Society	M/s. Arch dome Consultancy
24	507	1 Al Nad	Aster Hospital	Al Qasimia, Sharjah	M/s. Dr. Moopens Holdings FZC	M/s. Al Hilal Engineering Consultants
25	510	245-511	G+4	Dubai	M/s. Wasl LLC	M/s. Bel Yoahah Architectural
26	512	134-1406	3B+G+13F+HC+ Roof	Al Mamzar, Dubai	M/s. Ghassan Hassan Fatein Tahboub	M/s. Al Khawajah Engineering Consultancy
27	514	231-169, Al Nahda 1st	B+G+7+HC - Residential	Dubai	M/s. Dubai Investment	M/s. QHC Engg.
28	519	134-1413	2B+G+13+Roof	Al Mamzar, Dubai	M/s. Mahdi Ali Hassan	M/s. BH.NS Engg. Consultants
29	520	326-1071	3B+G+8+Roof	Al Jaddaf, Dubai	M/s. Ibrahim Ahmed Al Marzoughi	M/s. Al Hilal Engineering Consultants

## Major Completed Projects

S.No	REF	PLOT No.	PROJECT	LOCATION	CLIENT	CONSULTANT
1	333	241-291	2B+G+12+Terrace	Al Nahda 2, Dubai	M/s. Abdul Qader Al Sharafi	M/s. Dartin Consultant
2	341	CBD-09	B+G+10	Internet City Block Al Warsan, Dubai	M/s. Hamad Al Arif	M/s. Belyoahah Eng. Consultants
3	346	133-540	B+G+3 Floor + Roof Gym	Hoz Al Anz, Dubai	M/s. Mohammad Abdul Rahman Al Sharafi	M/s. Belyoahah Eng. Consultants
4	356	316-601	B+G+7+HC	Al Rafa, Dubai	M/s. Mohamme A.R.M. Al Ali	M/s. Fraser Nag. Engg.
5	370	319-158	2B+G+3+HC	Oud Metha, Dubai	M/s. Mohammed Ibrahim	M/s. Adan Saffarini
6	378	312-1505	B+G+M+2 Flr.	Al Souq Al Kabeer, Dubai	M/s. Awqaf & Minors Affairs Foundation	M/s. Al Turath Engg. Consultant
7	380	373-1329	2B+G+8	Al Barsha	M/s. Saeed Khalfan Ahmed and Ali Badi Awadi	M/s. Orion Consultants
8	382	332-284	G+2+Roof	Al Qusais, Dubai	M/s. Ali Ahmed Khalfan Bin Ghalitah	M/s. Adan Saffarini
9	385	318-1237	2B+G+m+2+R	Karama, Dubai	M/s. Ahmed Sultan Al Swaidi	M/s. Al Hilal Engg.
10	393	421-727	G+3+HC	Al Warqa'a	M/s. Hamad Al Arif	M/s. Local Engineering
11	399	318-377	B+G+3	Al Karama	M/s. Shaikh Rashid Bin Saeed Al Makhtoum	M/s. Zabeel Consultants
12	402	598-1205	B+G+6	DIP-I	M/s. Dubai Investment	M/s. Dewan Al Emara
13	420	333-1064	2B+G+3+R	Al Bada	M/s. Mohammed Yousuf Khoury	M/s. Al Baha Engg. Consultant
14	424	598-1220	Clinic (B+G+3+Gym + Roof	DIP-I	M/s. Dubai Investment	M/s. A to Z Consultant
15	437	597-788	Dubai Int'l Driving Centre	DIP-I	M/s. Dubai Investment	M/s. Access Engineering
16	434	558-C	G+5P+HC+18 Flr. Residential	Al Mamzar, Sharjah	M/s. Hureia Al Sayed	M/s. Mazaya Consulting Engineers
17	435	A-129	G+5P+H.C+25	Al Khan, Sharjah	M/s. Salah Awad Al Fargalh	M/s. Mazaya Consultants
18	449	354-379 & 354-955	2B+G+M+ 2 Car Showroom + Workshop	Al Quoz 1st, Dubai	M/s. Galdari Real Estate Co. Ltd.	M/s. Arif & Bintok
19	465	245-585	B+G+12+Roof. (Resi.)	Al Nahda 2nd, Dubai	M/s. Ahmad Mohammad Saeed Bin Humaidan	M/s. Al Ajmi Engineering Consultants
20	466	312-1517	Al Fahidi Super Market B+G+1	Bur Dubai, Dubai	M/s. Dubai Municipality	M/s. Gulf Engg. Consultants
21	467	232-203	2B+G+10+H.C (Resi.)	Al Qusais, Dubai	Mona Ali Mohd Ali	M/s. National Engg. Consultants

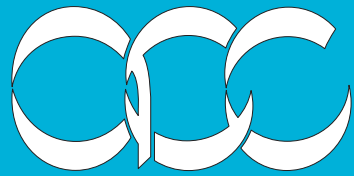

AL-ARIF  
CONTRACTING CO.LLC

# Certification

Certification







Sales Leadership Award, 2008

# *M'Sharie Annual Award 2008*

## **Sales Performance Leadership Award**

Presented to

# **Al Arif Contracting Company LLC**

in recognition of the company's management and entire staff  
for their contribution and achievements



مشاريك  
**M'SHARIE**  
venture capital

إحدى شركات دبي كابيتال  
A Subsidiary of **DUBAI INVESTMENTS**

**Khalid Jassim Bin Kalban**  
Chairman, M'Sharie LLC

December 14 - 2009





# Certificate of Appreciation



This certificate is awarded to

**Al Arif Contracting Co. LLC**

in recognition of valuable contributions to the construction of

**"The Al Muhaisnah Union Mosque"**

A charity project under the patronage of wasl LLC—Projects Management Department  
in line with the celebration of 42nd UAE National Day, 2013





27th November 2013



012

Certificate Number  
1893

Date of initial registration  
24 June 2011

Date of last issue  
24 June 2011

Date of expiry  
23 June 2014

REGISTRATION CERTIFICATE



**BM TRADA certify that the  
Environmental Management System of**

**AL ARIF CONTRACTING CO. (L.L.C.)**  
P.O. Box 6170  
Dubai  
United Arab Emirates

**complies with the requirements of ISO 14001:2004**

**Scope of Certification**  
Building Contracting



Signed on behalf of BM TRADA Certification Ltd  
Dr Peter Beele, Chief Operating Officer

Chiltern House, Stocking Lane, High Wycombe, Buckinghamshire, HP14 4ND

Further clarification regarding the scope of this certificate and verification  
of the certificate is available through BM TRADA  
at the above address or at [www.bmtrada.com](http://www.bmtrada.com)

This certificate remains the property of BM TRADA Certification Ltd  
This certificate and all copies or reproductions of the certificate shall be returned  
or destroyed if requested by BM TRADA Certification Ltd

For multisite clients the scope of certification shown above includes  
processes/activities that are performed by the network of sites  
shown in Appendix A

The use of the accreditation mark indicates accreditation in respect  
of those activities covered by the accreditation certification 012





012

**Certificate Number**  
8431

**Date of initial registration**  
24 June 2011

**Date of last issue**  
24 June 2011

**Date of expiry**  
23 June 2014

REGISTRATION CERTIFICATE



**BM TRADA certify that the  
Quality Management System of**

**AL ARIF CONTRACTING CO. (L.L.C.)**  
P.O. Box 6170  
Dubai  
United Arab Emirates

**complies with the requirements of ISO 9001:2008**

**Scope of Certification**  
Building Contracting



Signed on behalf of BM TRADA Certification Ltd  
Dr Peter Beele, Chief Operating Officer

Chiltern House, Stocking Lane, High Wycombe, Buckinghamshire, HP14 4ND

Further clarification regarding the scope of this certificate and verification  
of the certificate is available through BM TRADA  
at the above address or at [www.bmtrada.com](http://www.bmtrada.com)

This certificate remains the property of BM TRADA Certification Ltd  
This certificate and all copies or reproductions of the certificate shall be returned  
or destroyed if requested by BM TRADA Certification Ltd

For multisite clients the scope of certification shown above includes  
processes/activities that are performed by the network of sites  
shown in Appendix A

The use of the accreditation mark indicates accreditation in respect  
of those activities covered by the accreditation certification 012



012

Certificate Number  
531

Date of initial registration  
24 June 2011

Date of last issue  
24 June 2011

Date of expiry  
23 June 2014

REGISTRATION CERTIFICATE



**BM TRADA certify that the Occupational  
Health & Safety Management System of**

**AL ARIF CONTRACTING CO. (L.L.C.)**  
P.O. Box 6170  
Dubai  
United Arab Emirates

**complies with the requirements of OHSAS 18001:2007**

**Scope of Certification**  
Building Contracting



Signed on behalf of BM TRADA Certification Ltd  
Dr Peter Beele, Chief Operating Officer

Chiltern House, Stocking Lane, High Wycombe, Buckinghamshire, HP14 4ND

Further clarification regarding the scope of this certificate and verification  
of the certificate is available through BM TRADA  
at the above address or at [www.bmtrada.com](http://www.bmtrada.com)

This certificate remains the property of BM TRADA Certification Ltd  
This certificate and all copies or reproductions of the certificate shall be returned  
or destroyed if requested by BM TRADA Certification Ltd

For multisite clients the scope of certification shown above includes  
processes/activities that are performed by the network of sites  
shown in Appendix A

The use of the accreditation mark indicates accreditation in respect  
of those activities covered by the accreditation certification 012





012

Certificate Number  
2033

Date of initial registration  
19 April 2012

Date of last issue  
19 April 2012

Date of expiry  
18 April 2015

REGISTRATION CERTIFICATE



**BM TRADA certify that the  
Environmental Management System of  
Power Factor Electromechanical Works (LLC)**  
P.O. Box 241726  
Dubai  
United Arab Emirates

**complies with the requirements of ISO 14001:2004**

**Scope of Certification**  
Provision of MEP Contracting

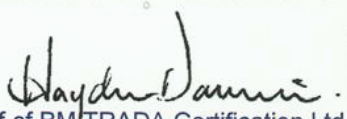

  
Signed on behalf of BM TRADA Certification Ltd  
Hayden Davies, Group Director  
Chiltern House, Stocking Lane, High Wycombe, Buckinghamshire, HP14 4ND

Further clarification regarding the scope of this certificate and verification  
of the certificate is available through BM TRADA  
at the above address or at [www.bmtrada.com](http://www.bmtrada.com)

This certificate remains the property of BM TRADA Certification Ltd  
This certificate and all copies or reproductions of the certificate shall be returned  
or destroyed if requested by BM TRADA Certification Ltd

For multisite clients the scope of certification shown above includes  
processes/activities that are performed by the network of sites  
shown in Appendix A

The use of the accreditation mark indicates accreditation in respect  
of those activities covered by the accreditation certification 012





012

**Certificate Number**  
**8992**

**Date of initial registration**  
16 March 2012

**Date of last issue**  
16 March 2012

**Date of expiry**  
15 March 2015

REGISTRATION CERTIFICATE



**BM TRADA certify that the  
Quality Management System of**

**Power Factor Electromechanical Works (LLC)**

P.O. Box 241726

Dubai

United Arab Emirates

**complies with the requirements of ISO 9001:2008**

**Scope of Certification**

Provision of MEP Contracting

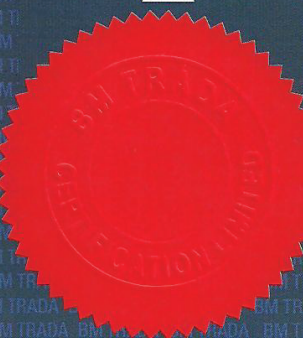

Signed on behalf of BM TRADA Certification Ltd

Hayden Davies, Group Director

Chiltern House, Stocking Lane, High Wycombe, Buckinghamshire, HP14 4ND

Further clarification regarding the scope of this certificate and verification  
of the certificate is available through BM TRADA  
at the above address or at [www.bmtrada.com](http://www.bmtrada.com)

This certificate remains the property of BM TRADA Certification Ltd  
This certificate and all copies or reproductions of the certificate shall be returned  
or destroyed if requested by BM TRADA Certification Ltd

For multisite clients the scope of certification shown above includes  
processes/activities that are performed by the network of sites  
shown in Appendix A

The use of the accreditation mark indicates accreditation in respect  
of those activities covered by the accreditation certification 012





012

Certificate Number  
609

Date of initial registration  
18 April 2012

Date of last issue  
18 April 2012

Date of expiry  
17 April 2015

REGISTRATION CERTIFICATE



**BM TRADA certify that the Occupational  
Health & Safety Management System of**

**Power Factor Electromechanical Works (LLC)**

P.O. Box 241726

Dubai

United Arab Emirates

**complies with the requirements of OHSAS 18001:2007**

**Scope of Certification**  
Provision of MEP Contracting



Signed on behalf of BM TRADA Certification Ltd  
Hayden Davies, Group Director

Chiltern House, Stocking Lane, High Wycombe, Buckinghamshire, HP14 4ND  
Further clarification regarding the scope of this certificate and verification  
of the certificate is available through BM TRADA  
at the above address or at [www.bmtrada.com](http://www.bmtrada.com)

This certificate remains the property of BM TRADA Certification Ltd  
This certificate and all copies or reproductions of the certificate shall be returned  
or destroyed if requested by BM TRADA Certification Ltd

For multisite clients the scope of certification shown above includes  
processes/activities that are performed by the network of sites  
shown in Appendix A



Management Service

# CERTIFICATE

The Certification Body  
of TÜV SÜD Management Service GmbH  
certifies that

**STROMEK Emirates Foundations LLC**  
P. O. Box 62124  
Dubai - United Arab Emirates

has established and applies  
a Quality Management System for

**Civil & Foundation Contractors  
(Piling & Shoring)**

An audit was performed, Report No. **70777263**  
Proof has been furnished that the requirements  
according to

**ISO 9001:2008**

are fulfilled. The certificate is valid until **2014-05-18**  
Certificate Registration No. **12 100 40762 TMS**

Munich, 2011-05-20



QMS-TGA-ZM-07-92





Management Service

# CERTIFICATE

The Certification Body  
of TÜV SÜD Management Service GmbH  
certifies that

**STROMEK Foundations Contractors LLC**  
Musaffah Industrial Zone – ICAD 1  
Abu Dhabi, United Arab Emirates

has established and applies  
a Quality Management System for

**Civil & Foundation Contractors - (Piling & Shoring)**

An audit was performed, Report No. **70781891**  
Proof has been furnished that the requirements  
according to

**ISO 9001:2008**

are fulfilled. The certificate is valid until **2014-07-31**

Certificate Registration No. **12 100 41171 TMS**

Munich, 2011-08-01



QMS-TGA-ZM-07-92



Management Service

# CERTIFICATE

The Certification Body  
of TÜV SÜD Management Service GmbH  
certifies that

**STROMEK SAUDI FOUNDATIONS LLC**  
P. O. Box 84928  
AL Riyadh 11681, Kingdom of Saudi Arabia

has established and applies  
a Quality Management System for

**Civil & Foundation Contractor**  
(Piling, Shoring, Excavation and Dewatering)

An audit was performed, Report No. **70785408**  
Proof has been furnished that the requirements  
according to

**ISO 9001:2008**

are fulfilled. The certificate is valid until **2014-11-15**  
Certificate Registration No. **12 100 41843 TMS**

Munich, 2011-12-01



QMS-TGA-ZM-07-92

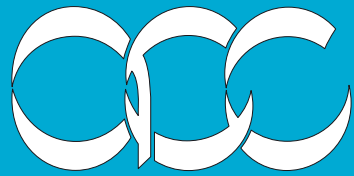

AL-ARIF  
CONTRACTING CO.LLC

# Documents

Documents







## رخصة تجارية Commercial License

معلومات الرخصة / License Details			
License No.	216410	رقم الرخصة	
Company Name	AL ARIF CONTRACTING CO (L.L.C)	اسم الشركة	شركة العارف للمقاولات (ذات مسؤولية محدودة)
Trade Name	AL ARIF CONTRACTING CO (L.L.C)	الاسم التجاري	شركة العارف للمقاولات (ذ.م.م)
Legal Type	Limited Liability Company(LLC)	الشكل القانوني	ذات مسؤولية محدودة
Expiry Date	29/01/2015	تاريخ الإصدار	21/04/1975
D&B D-U-N-S ® No.	552290694	رقم الرخصة الأم	216410
Register No.	45620	عضوية الغرفة	1729
		Issue Date	
		Main License No	
		DCCI No.	

أطراف الرخصة / License Holders			
Share / الحصص	Role / الصفة	Nationality / الجنسية	Name / الاسم
	Manager / مدير	United Arab Emirates / الإمارات	5025
			حمد عبدالكريم نصرالله العارف

نشاط الرخصة التجارية / License Activities			
Building Contracting			مقاولات البناء
العنوان / Address			
Telephone	971-4-3979555	تليفون	P.O. Box 6170
Fax	971-4-3979666	فاكس	Parcel ID 0
Mobile No		الهاتف المحمول	مكتب ملك حمد عبدالكريم نصرالله العارف - بردي - المصلى -
ملاحظات / Remarks			
مقاولات بناء (غير محدودة الطوابق).			

Print Date 30/01/2014 11:23 تاريخ الطباعة

Receipt No. 11612683 رقم الإيصال

Activity  
Owners

الجهات التي لها  
صلاحية متابعة أنشطة

( وثيقة إلكترونية معتمدة وصادرة بدون توقيع من دائرة التنمية الاقتصادية. لمراجعة صحة البيانات الواردة في الرخصة يرجى زيارة الموقع <http://www.dubaided.gov.ae> )  
(Approved electronic document issued without signature by the Department of Economic Development. To verify the license kindly visit <http://www.dubaided.gov.ae>)

## غرفة دبي DUBAI CHAMBER

### شهادة تسجيل العضوية Membership Certificate

License no.	216410	رقم الرخصة	216410
Membership no.	1729	رقم العضوية	1729
Registration no.	45620	رقم السجل التجاري	45620
Trade Name	AL ARIF CONTRACTING CO (L.L.C)	الاسم التجاري	شركة العارف للمقاولات (ذ.م.م)
Legal Status	Limited Liability Company	الشكل القانوني	شركة ذات مسؤولية محدودة
Activity	Building contracting	نوع النشاط	مقاولات البناء
Member Since	03/05/1976	تاريخ الانضمام	03/05/1976
Date of Issue	30/01/2014	تاريخ الإصدار	30/01/2014
Expiry Date	29/01/2015	تاريخ الانتهاء	29/01/2015

#### Remarks

This certificate shall be invalid incase of any alteration without chamber's authorization

For online verification of this Certificate, please visit our website  
<http://www.dubaichamber.ae/verify>

غرفة تجارة وصناعة دبي  
Dubai Chamber of Commerce & Industry

هاتف 4 2280000 (+971) Tel (Outside UAE) 800 CHAMBER (800 2426237) Tel (Within UAE) P.O. Box 1457 - Dubai, U.A.E.  
فاكس 4 2211646 (+971) Fax customercare@dubaichamber.ae | [www.dubaichamber.ae](http://www.dubaichamber.ae)

#### الملاحظات

تعتبر هذه الشهادة لاغية في حال أي كسب أو تعديل عليها دون اعتماد ذلك من الغرفة

للتأكد من صحة بيانات الشهادة يرجى الرجوع إلى موقع الغرفة  
<http://www.dubaichamber.ae/verify>

GOVERNMENT OF SHARJAH  
Economic Development Department



حُكُومَةُ الشَّارِقَةِ  
دائرة التنمية الاقتصادية

## رخصة تجارية

## Trading License



### License Details تفاصيل الرخصة

Issue Date	2004/08/28	تاريخ الإصدار	License No.	529351	رقم الرخصة
Expiry Date	2014/08/26	تاريخ الإنتهاء	Registration No.	23146	رقم السجل

Trade Name AL ARIF CONT. CO. LLC SHJ. BR.

الاسم التجاري شركة العارف للمقاولات ذ.م.م - فرع الشارقة

Legal status Branch for Local Company

الشكل القانوني فرع لشركة محلية

### License Members أطراف الرخصة

الحصص	الصفة	رقم الهوية / الجواز	الجنسية	اسم المستثمر	رقم المستثمر
Shares	Type	ID/Passport No.	Nationality	Investor Name	Investor No.
%50	شريك		الإمارات	العارف للاستثمار ش ذ م م	77588
%50	شريك	784197485732461	الإمارات	حمد عبدالكريم نصر الله العارف	27380

المدير حمد عبدالكريم نصر الله العارف

أنشطة الرخصة مقاولات فئة أولى إختصاص مبانى

العنوان الشارقة الشويهيين/الشارقة-مساحة الحصن - مركز سارة مكتب رقم 710 ملك السور للاستثمار ذ م م

رقم الهاتف: 0506242321

صندوق البريد: 68016 الشارقة

### Notes الملاحظات

- خروج شريك, دخول شريك

2013/09/26

تاريخ الطباعة

1000006

رقم المستخدم

هذه الوثيقة رسمية ولا تحتاج لختم أو توقيع وللتأكد من صحة البيانات يرجى زيارة الموقع [www.sedd.ae](http://www.sedd.ae)

This Document is official. It doesn't need to be stamped or signed . To view license detail visit [www.sedd.ae](http://www.sedd.ae)



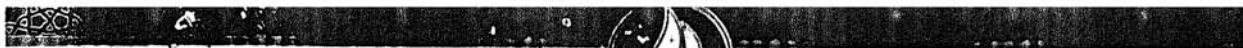

ایصال رقم : 37711

**State of Qatar**  
**Ministry of Business & Trade**  
Registration & Commercial Licenses Department



دولة قطر  
وزارة الأعمال والتجارة  
إدارة التسجيل والتراخيص التجارية

## رخصة تجارية

مكتب تجاري

رقم الطلب: 2012/7236	رقم الرخصة: 86663
البطاقة الشخصية: اسم المرخص له: شركة ايفشنسي للتجارة والمقاولات وشريكها	الجنسية: قطرية
البطاقة الشخصية: المدير المسؤول: سعيد هاشم محمد عبدالرحمن المير	الجنسية: قطري
الاسم التجاري: شركة العارف القطرية للمشاريع (ذ م م)	
نوع العمل: انشاءات عامه (مقاولات عامه)	
	
موقع المحل: 23 - فريج بن محمود	شارع: 850 - قطري بن الفجاءة
عقار رقم: 70-ع	ملك: جاسم جبر محمد ال ثاني (دور 1 شقة 70)
<p>صدرت هذه الرخصة بموجب القانون رقم 3 لسنة 1975 وعلى المرخص له مراعاة الالتزام بأحكام القانون ولوائح التنفيذ بالإضافة إلى الشروط الخاصة بالتراخيص ومنها ضرورة تجديد في الموعد المحدد وإخطار الإدارة فور حدوث أية تعديلات في البيانات اعلاه.</p>	

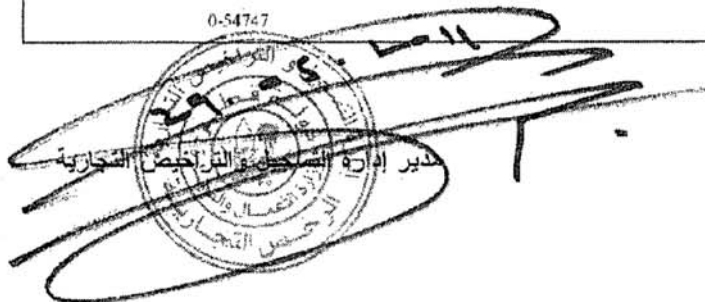

تاريخ الاصدار: 2012-05-29

تاريخ الإنتهاء: 2014-05-27



المجلد: العرب والسعوديين

وزارة التجارة والصناعة

الرقم: ١٠٦٠٢٩١٨١٦

التاريخ : ١٤٣١/١٠/٨

شادان سجده

شركة المعارف للمقاولات

نوعها : \_\_\_\_\_ محمودة إبراهيم أسد خليلجي

١٤٨٥/٠١/٢٣ وتنتهي في: ١٤٣٥/٠١/٢٣ تبدأ من: ٥٠ مدة الشركة:

مركزها الرئيسي - حي الملك فهد - طريق الملك فهد - مبنى العليا

ص.ب: \_\_\_\_\_  
الرمز البريدي: \_\_\_\_\_  
هاتف: \_\_\_\_\_  
تلكس: \_\_\_\_\_  
فاكس: \_\_\_\_\_

النشاط الأعمال حفرة أساسات وتثبيت الركائز ومقاولات البناء والصيانة العامة واعمال

التمديدات والتكريرات الصحية وأعمال التمديدات الكهربائية ، وشوارع

الإراضي لإقامة مداني عليها واستثمارها بالبيع أو التآجير لصالح الشركة

ساستنا العقارات الواعدة مكة المكرمة والمدنية المنورة

رأس المال: \_\_\_\_\_

المَدِينُونَ: ١ - حَمْدُكَ يَا رَبِّ الْعَالَمِينَ

[illegible]

100

---

---

---

حسب ما نص عليه عقد الشركة

يشهد مكتب السجل التجاري بمدينة  
بأنه تم تسجيل الشركة آنفة الذكر بسجل مدينة

وتنتهي صلاحية الشهادة في : تاريخ : ٠٧/٠٩/٢٠٠١  
بموجب الإيضاح رقم : ٤٣١/٠٨/٢٠٠١

مدير السجل التجاري ، الاسم : \_\_\_\_\_

التوقيع :



*James M. Smith*



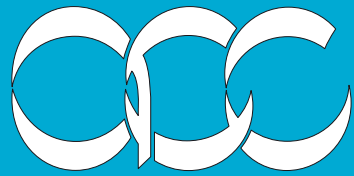

AL-ARIF  
CONTRACTING CO.LLC

# Resources

Resources



- • Manpower & Major Asset Lists as of 2013
  - Manpower
  - Plant & Equipments and Vehicles
  - Accommodation & Storage Facilities

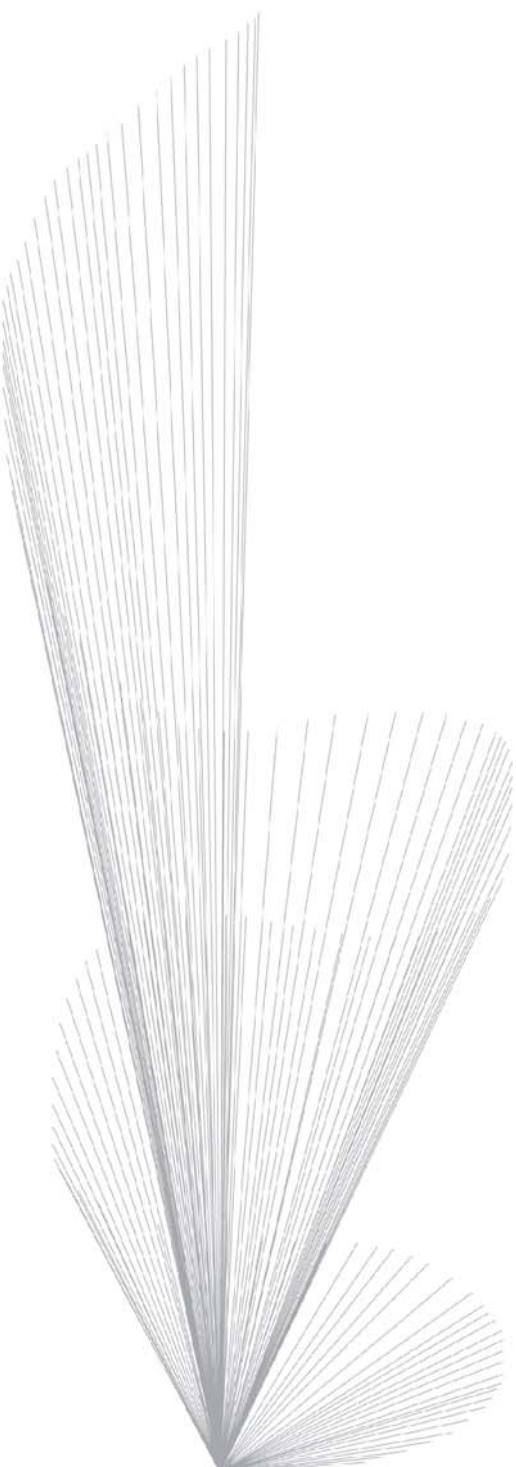

# Manpower

## A) Key Personnel

Name of Staff	Designation	Date of Join in our Company	Experience in Years
Mr. Hamad Abdul Karim Nasrallah Al Arif	Chairman Cum managing Director	01-01-1991	22
Mr. Attia Mahmoud Baiyomi	General Manager	01-07-1995	18
Mr. Khalid Al Arif	Director - Admin Services	23-04-2011	21
Mr. Monikandan	Group Finance & Admin Manager	01-03-1994	19
Mr. Ameer Samir Ameen Budair	Deputy General Manager	18-11-2000	15

## B) Key Staffs

Sl. No	Designation	Count
1	Senior Management	9
2	Managers	41
3	Administration Staffs	179
4	Engineer's	220
5	Site and Other Staff	273
Total		722

## C) Manpower Distribution

Sl. No	Designation	Count
1	Mason	560
2	Carpenter	1268
3	Steel Fitter	180
4	Painter	127
5	M.E.P	790
6	Skilled	405
7	Unskilled	1942
Total		5272



## Plant & Equipments and Vehicles

Sl. No.	Name	No's
1	Earth Moving Equipmet	68
2	Earth Compaction Equipment	22
3	Concreting Equipment	62
4	Material Lifting and Handling Equipment	71
5	Personal Transportation Vehicles	119
6	Other Equipment	21
<b>Total</b>		<b>363</b>

## Accommodation & Storage Facilities

### **A) Labour Accommodation**

(i) Al Quoz Labour Camp (Plot No. 369-0190 at Al Quoz Industrial Area)

Total Capacity	Total Land Area	No. of People
459 Rooms	119,694 Sq.ft	2,295 No's

(ii) Sharjah Labour Camp (Plot No. 2789 B at Sharjah Industrial Area)

Total Capacity	Total Land Area	No. of People
77 Rooms	21,853 Sq.ft	385 No's

(iii) DIP Labour Camp

Total Capacity	Total Land Area	No. of People
82 Rooms	30,774 Sq.ft	410 No's

(iv) Al Quoz Labour Camp (2) (Plot No. 365-702 at Al Quoz Industrial Area)

Total Capacity	Total Land Area	No. of People
143 Rooms	52385 Sq.ft	715 No's

(v) Al Quoz Labour Camp (3) (Plot No. 358-624 at Al Quoz Industrial Area)

Total Capacity	Total Land Area	No. of People
321 Rooms	50,002 Sq.ft	1,605 No's

(vi) Sonapour Labour Camp (Plot No. 264-1034)

Total Capacity	Total Land Area	No. of People
467 Rooms	56,914 Sq.ft	1,868 No's

(vii) Ajman Labour Camp (Plot No. 194 & 194/1 Al Jurf Industrial Estate)

Total Capacity	Total Land Area	No. of People
48 Rooms	74,000 Sq.ft	192 No's

### **B) Warehouse**

(i) Aweer Warehouse (Plot No. 613-1663 at Ras Al Khor Industrial Area (Al Aweer))

No. of Units	Total Land Area	Usage
9 Warehouses	120,164 Sq.ft	Warehouse & Work Shops

(ii) Sharjah Warehouse (Plot No. 186-3184 at Ind. 18, Sharjah)

No. of Units	Total Land Area	Usage
G+ M Warehouses	103,103 Sq.ft	Warehouse & Shops